



Authorised Suppliers

The Widebeam Collection

**PRICE
PROMISE**
GUARANTEE

Our **PRICE PROMISE GUARANTEE** is your reassurance that you *cannot buy cheaper*. Being an **Approved Supplier** means we sell at exactly the same price as the manufacturers so we cannot be beaten on price, *even if you go direct!*

The Abode 70ft x 12ft 6"

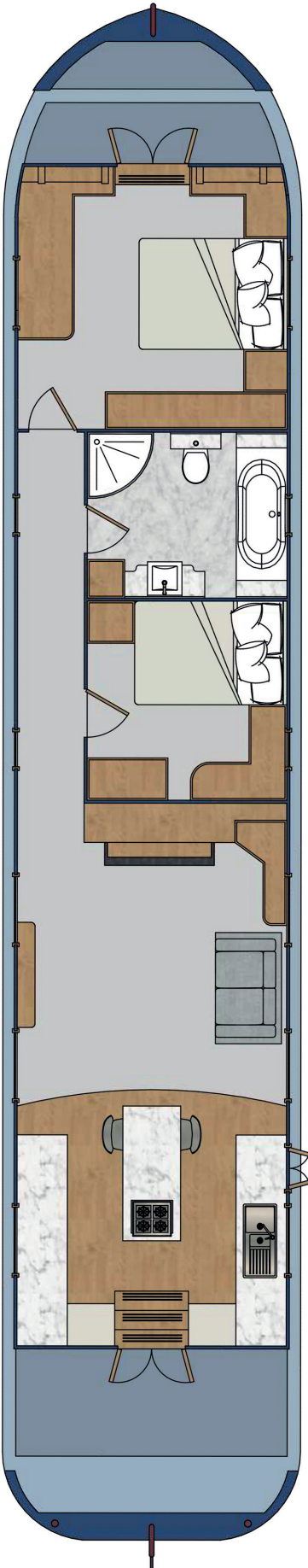

The Abode

from 64ft x 12ft 6"

The size and high specification of the Abode widebeam boat makes it the ideal alternative to a luxury apartment. In 2019 the craft was remodelled to feature a number of modifications and enhancements. Packed with appliances, exclusive features and sumptuous decorative touches, the Abode provides all the benefits of on-water living with virtually none of the compromises.

The galley, saloon and bathroom are fitted out to exceptional standards, including such refinements as a built-in wine cooler, 42" flat screen TV, a large bath with optional whirlpool and much, much more.

It's also the perfect boat for entertaining. The standard size is 64' x 12' 6" (other sizes available), resulting in a spacious interior with two double bedrooms and a square stern with upholstered built-in seating area that's ideal for al fresco snacks and drinks.

Beautiful but also very practical, the Abode from the New & Used Boat Co has been planned in every detail - from the choice of engine to the range of fabrics - to suit those independent-minded people who want to make the waterways their home.

Interior Finish

The interior lining is of oak or ash faced ply with matching hardwood trims, complimented by tongue & groove effect ceiling, plus painted or wall papered panels above the gunwale. Interior woodwork is finished in a high-performance, water based, clear acrylic which is extremely hardwearing, has minimal impact on the natural colour of the timber and is kinder to the environment.

Flooring options have been carefully selected for their aesthetic appeal and durability with a choice of carpet, laminates or solid hardwood in a comprehensive range of colours and designs.



Galley

The galley has some stunning curved unit doors in a shaker style, as well as boasting generous amounts of storage and granite work surfaces.

It is packed with all the modern appliances you need including a large fridge, freezer, slimline wine cooler, oven, microwave and a washer dryer.

A central island with a hardwood worksurface and breakfast bar features a 5 burner hob with extractor above.

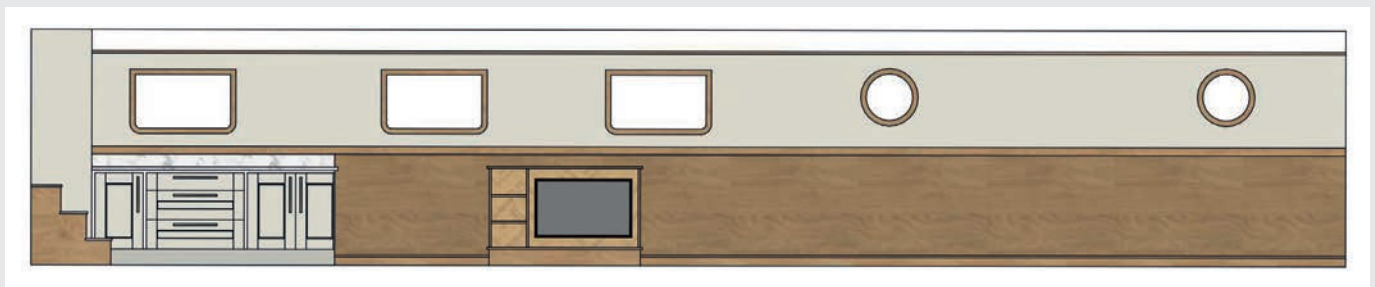

Saloon

The attractive saloon area is the perfect space to make your own with freestanding furniture.

A state-of-the-art 42" flat screen TV & DVD is built in to an under-gunwale unit with options available for a satellite system too.

A fireplace with solid fuel stove set on a tiled hearth is centrally located on the forward bulkhead. Additional atmospheric lighting is provided by picture lights.



Master bedroom

The spacious master bedroom offers generous amounts of storage with full width mirrored wardrobes and fitted drawers and cupboards.

Glazed doors leading on to the bow deck and large windows help create a light, airy ambience with wallpapered panels completing the striking, interior scheme.

A king size bed is standard and for extra luxury a 32" flat screen TV rises smoothly out of a unit opposite the footboard.



Bedroom two/Study option *(available on 70ft length)*

Amaze your guests with just how comfortable on-board living can be. This generous room offers a double bed with ample storage underneath, two wardrobes and a desk/dressing table with picture light above. If required this room can be reconfigured to offer one or two single berths.



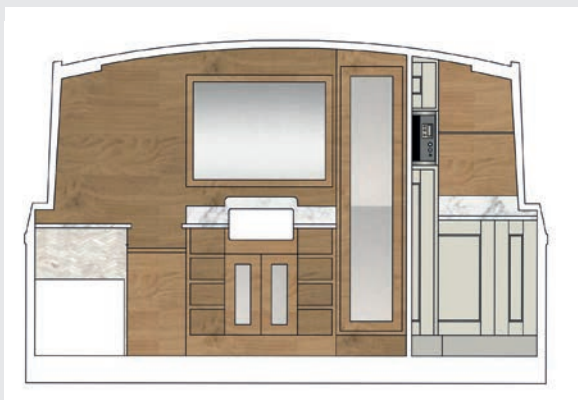

Bathroom

The Abode's spacious, beautiful and practical bathroom features a large 1200x800mm corner shower unit with screen, a full size bath, double hand basin with taps protruding from the wall to create that 5 star hotel feel. There's a vanity unit plus a clever alcove for your toiletries. There is also an electric macerator pump out toilet. This modern, luxury bathroom is further enhanced with glass panelled hardwood doors and granite worksurfaces.

Popular Optional Extras

- Canaline 70 Engine with PRM260 gearbox
- Pram cover
- Cratch & cover
- Rear bimini with LED lighting
- Satellite T.V. (Manual or self seeking)
- Coffee machine
- Teak effect decking
- Victron 3000/120 combi inverter/charger
- Double glazing
- Solar panels
- Whirlpool bath upgrade
- Curved stern with horseshoe shaped seating

Please ask a member of staff for detailed costings and our full list of optional extras.

Exterior Finish

Layers of high-performance primers and undercoats are applied to the craft before being painstakingly coach-painted in beautiful high-gloss marine enamel. For areas such as deck, roofs and gunwales a non slip coating is applied.

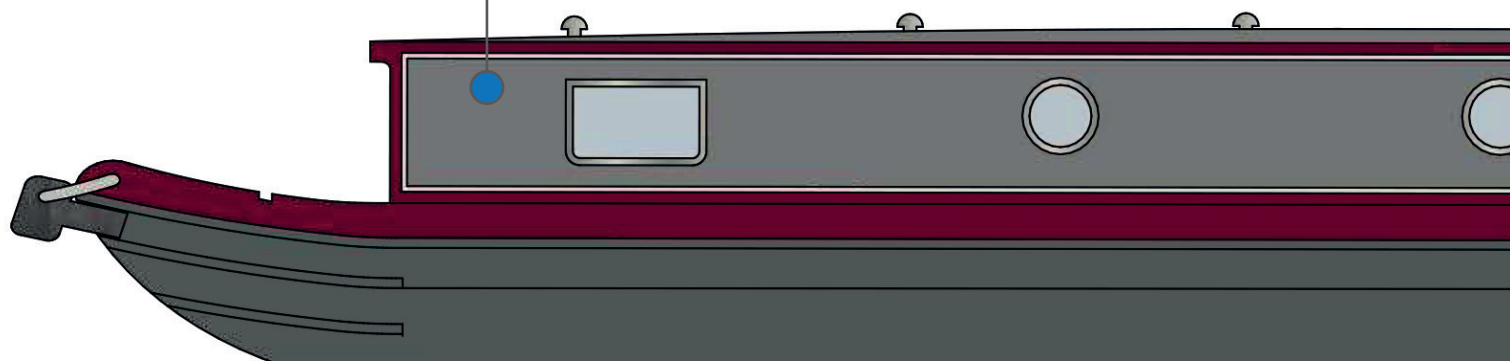

Technical

Steel Specification

10/6/5/4

Engine & Gearbox

Canaline 60, 4 cylinder diesel engine with twin alternators and PRM150 gearbox. Engine control panel with tachometer, water temperature, oil pressure and battery warning lights and multifunction LED display.

Heating & Hot Water System

In addition to the solid fuel stove in the saloon there is a Webasto diesel fired central heating system running three radiators and a heated towel rail, as well as a 13 gallon calorifier for hot water. The twin coil calorifier is also connected to the engine circuit providing heat for hot water when running.

Additionally a 1kw immersion heater is fitted to give hot water via shore power.

Electrics

The 240V system on board simply plugs in to the shore line providing power to the brushed stainless steel double sockets throughout the boat. When cruising, a Sterling 2500/70 pure sine wave inverter/charger ensures you are never without power.

4 x 110A domestic batteries, which are charged by a dedicated alternator, provide 12v power through the high quality, dedicated distribution panel which carries individual breakers for all the appliances, as well as voltage and amperage readouts.

There are also dedicated batteries for engine starting and the 95Kgf Vetus bow thruster.

Rear Deck Area

The square cruiser stern is the perfect area for socialising whilst out cruising or when moored up. The wraparound rear seating area provides plenty of storage and comes with weatherproof, upholstered, removeable cushions. The boat can be steered by either the hydraulic wheel steering or conventional tiller. Further seating/storage is provided alongside the steering position. Plenty of options are available to add your personal touch to this area too, like a pram cover as shown.

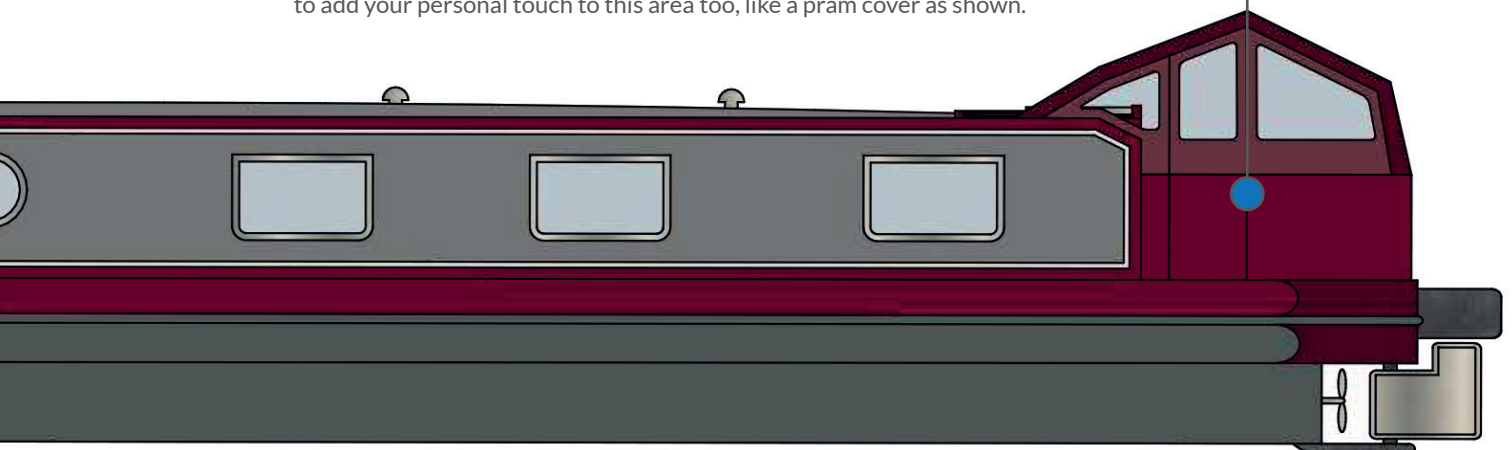

The Eurocruiser

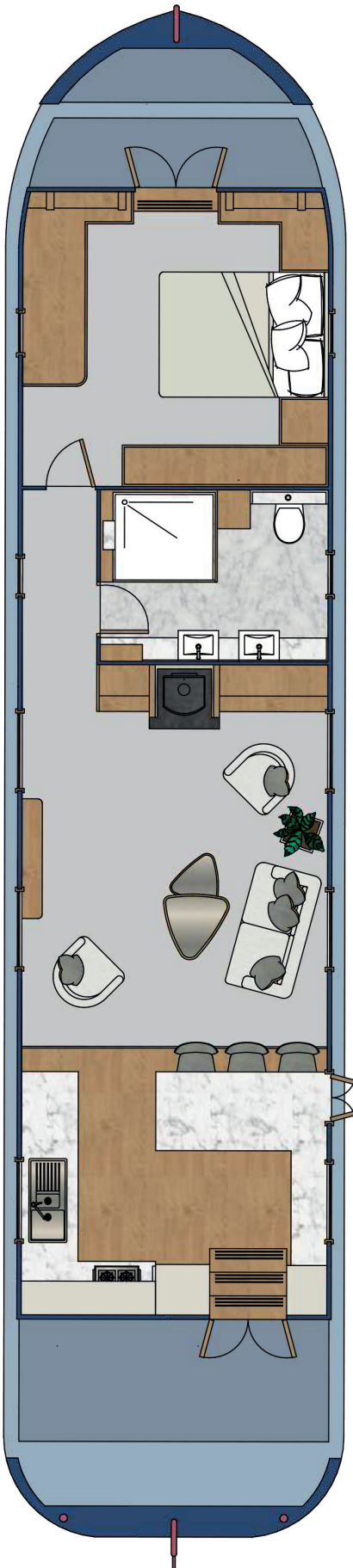

The Eurocruiser

from 60ft x 12ft 6"

Launched just over 3 years ago the Eurocruiser has gone on to become our best selling widebeam. In 2019 the Eurocruiser was remodelled to feature a number of modifications and enhancements. The distinctive square stern contains two attractive features – a wheel for steering, and built-in upholstered seating for socialising. At home on the canal and equally adept on the river, the Eurocruiser is a spacious, beautifully appointed craft that's perfect for residential or leisure use, whether in the UK or on the waterways of Europe.

The build quality on the Eurocruiser is evident from stem to stern. With a high gloss finish in marine enamel on the outside and fully lined inside with oak or ash veneer, this is a boat that keeps its good looks, year in, year out. Fixtures and fittings are to a high specification, including granite work surfaces, washer/dryer and much more as standard. Space and quality combine to make the whole boat a wonderfully welcoming environment.

With one and two bedroom versions available, the Eurocruiser is a boat you can customise with ease. From the boat's dimensions to the external colour scheme, through to flooring materials and curtain fabrics, we provide a very wide range to choose from. If you'd rather have a study than a second bedroom for example, just let us know.

Interior Finish

The interior lining is of oak or ash faced ply, left natural or painted with matching hardwood trims, complimented by tongue & groove effect ceiling. Interior woodwork is finished in a high-performance, water based, clear acrylic which is extremely hardwearing, has minimal impact on the natural colour of the timber and is kinder to the environment.

Flooring options have been carefully selected for their aesthetic appeal and durability with a choice of carpet, laminates or solid hardwood in a comprehensive range of colours and designs.



Galley

The large galley features contemporary units with plenty of storage and soft close doors and runners. Granite worksurfaces are fitted as standard as is a 4-burner full sized hob with granite splashback plus a stainless steel oven and separate grill.

There's also a household size stainless steel sink with monobloc tap, microwave, 12v fridge with freezer box and washing machine all supplied as standard.

The breakfast bar ensures a nice easy dining experience.

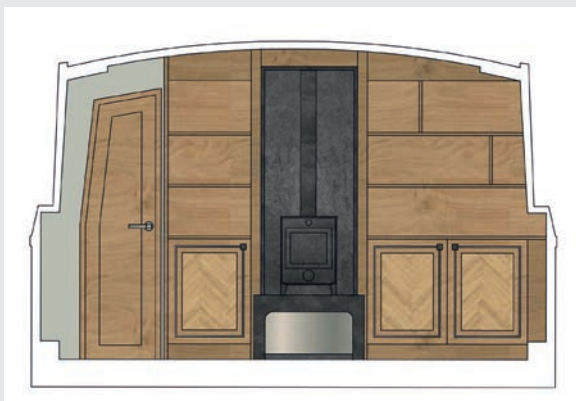
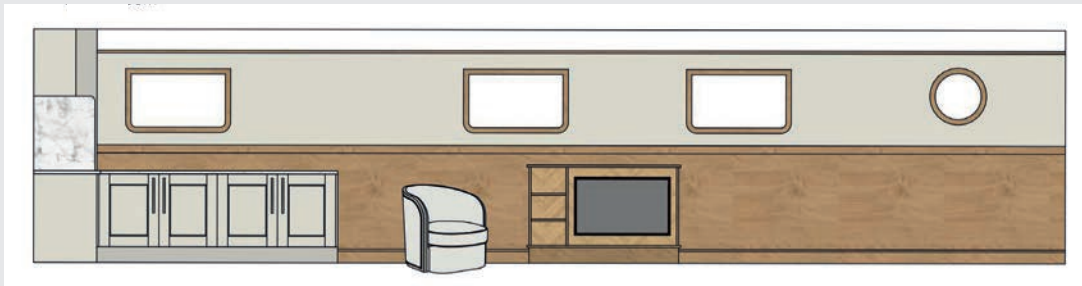
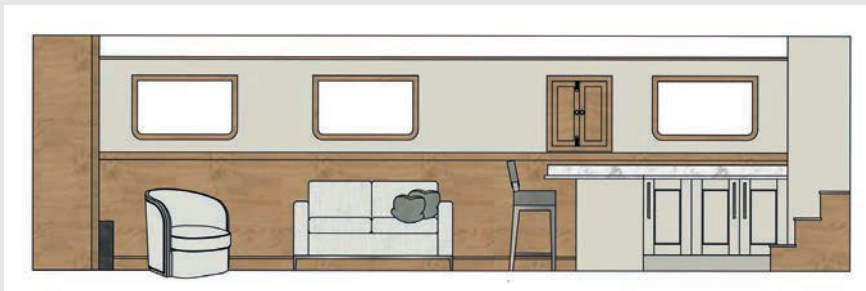

Saloon

The saloon area is designed for freestanding furniture. A 32" flat screen TV is built into a under-gunwale unit.

A solid fuel stove set in to a tiled hearth is centrally located on the forward saloon bulkhead with display units, shelving and storage on either side.

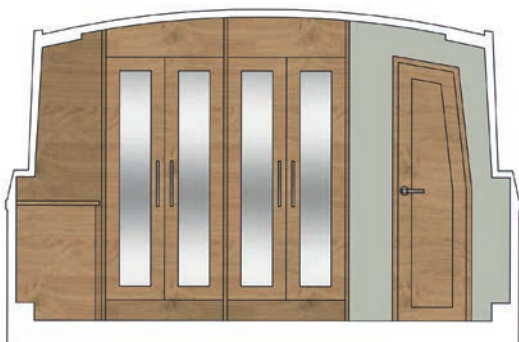

Master bedroom

The relaxing yet practical bedroom offers plenty of storage space, with a fixed double or king size bed with drawers under, bedside cabinets to both sides, full width mirrored wardrobes on the aft bulkhead, drawer unit opposite the foot of the bed and full height cupboards to either side of the glazed bow doors. There are ample 240v sockets in the bedroom as well as a TV aerial socket and reading lights over the head of the bed.

A second bedroom option can be fitted with a double bed, wardrobe and dressing table or a single bed, wardrobes and a desk/study area.

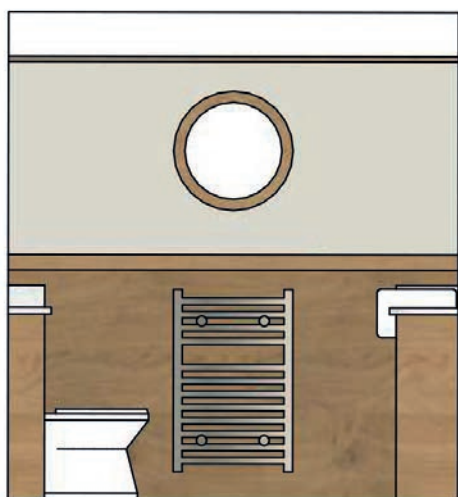
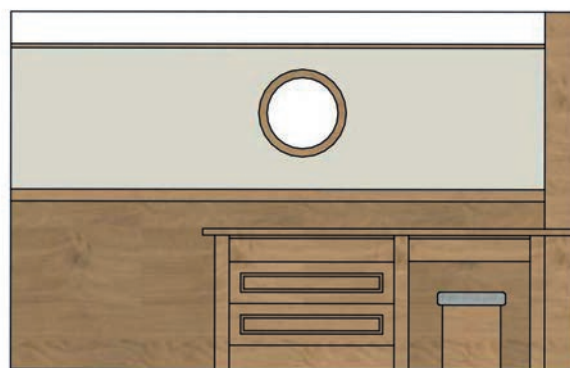

Bathroom

The spacious bathroom, with glass panelled hardwood doors, has a large corner 1200x800mm shower which is fitted with a waterproof panelling system that provides a contemporary and watertight finish. A feature vanity unit has a hand basin with taps, protruding out of the wall creating a 5 star hotel style feel, resting on the granite worksurface. An electric macerator pump out toilet is fitted as standard. All in all, a room that wouldn't be out of place in a modern day apartment.

Popular Optional Extras

- Canaline 70 Engine with PRM260 gearbox
- Curved stern with horseshoe shaped seating
- Pram cover
- Cratch & cover
- Rear bimini with LED lighting
- Satellite TV (manual or self seeking)
- Teak effect decking
- Victron 3000/120 combi inverter/charger
- Double glazing
- Solar panels
- Hospital silencer
- 2nd bedroom
- Black pack featuring: Black taps, sockets, light switches, shower enclosure and all iron monger (eg, mushroom/door vents, cabin hooks etc)

Please ask a member of staff for detailed costings and our full list of optional extras.

Exterior Finish

Layers of high-performance primers and undercoats are applied to the craft before being painstakingly coach-painted in beautiful high-gloss marine enamel. For areas such as deck, roofs and gunwales a non slip coating is applied.

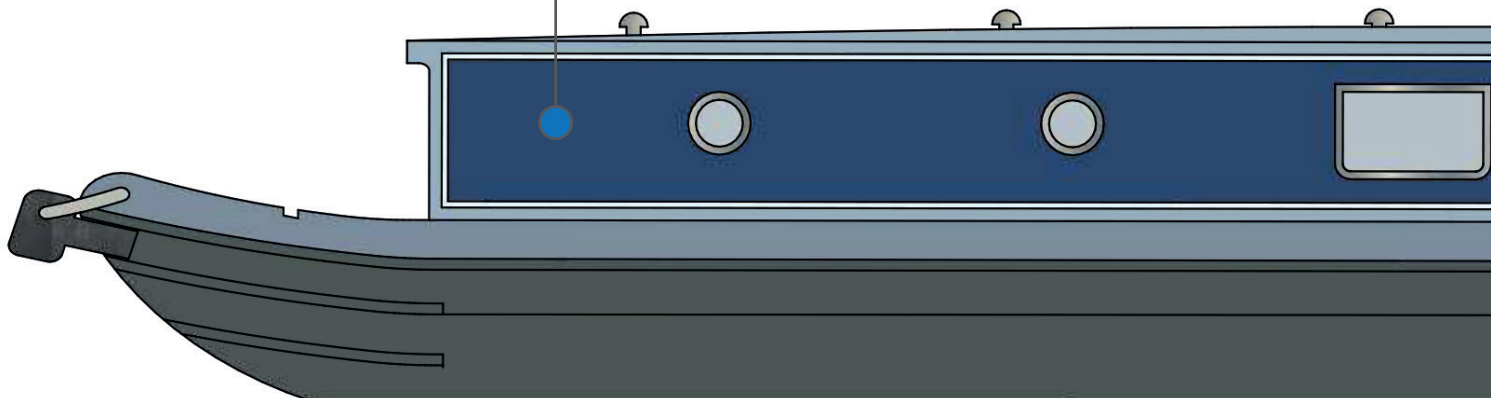

Technical

Steel Specification

10/6/5/4

Engine & Gearbox

Canaline 60, 4 cylinder diesel engine with twin alternators and PRM150 gearbox. Engine control panel with tachometer, water temperature, oil pressure and battery warning lights and multifunction LED display.

Heating & Hot Water System

In addition to the solid fuel stove in the saloon there is a Webasto diesel fired central heating system running three radiators and a heated towel rail, as well as a 13 gallon calorifier for hot water. The twin coil calorifier is also connected to the engine circuit providing heat for hot water when running.

Additionally a 1kw immersion heater is fitted to give hot water via shore power.

Electrics

The 240V system on board simply plugs in to the shore line providing power to the brushed stainless steel double sockets throughout the boat. When cruising, a Sterling 2500/70 pure sine wave inverter/charger ensures you are never without power.

3 x 110A domestic batteries, which are charged by a dedicated alternator, provide 12v power through the high quality, dedicated distribution panel which carries individual breakers for all the appliances, as well as voltage and amperage readouts.

There are also dedicated batteries for engine starting and the 95Kgf Vetus bow thruster.

Rear Deck Area

The square cruiser stern is the perfect area for socialising whilst out cruising or when moored up.

The wraparound rear seating area provides plenty of storage and comes with weatherproof, upholstered, removeable cushions. The boat can be steered by either the hydraulic wheel steering or conventional tiller. Further seating/storage is provided alongside the steering position. Plenty of options are available to add your personal touch to this area too.

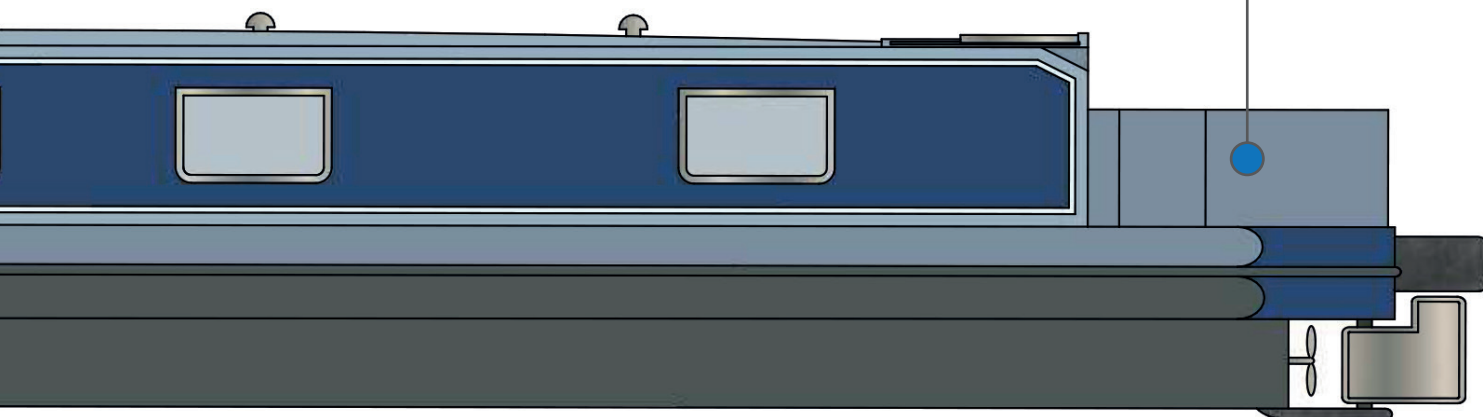

Baby Eurocruiser

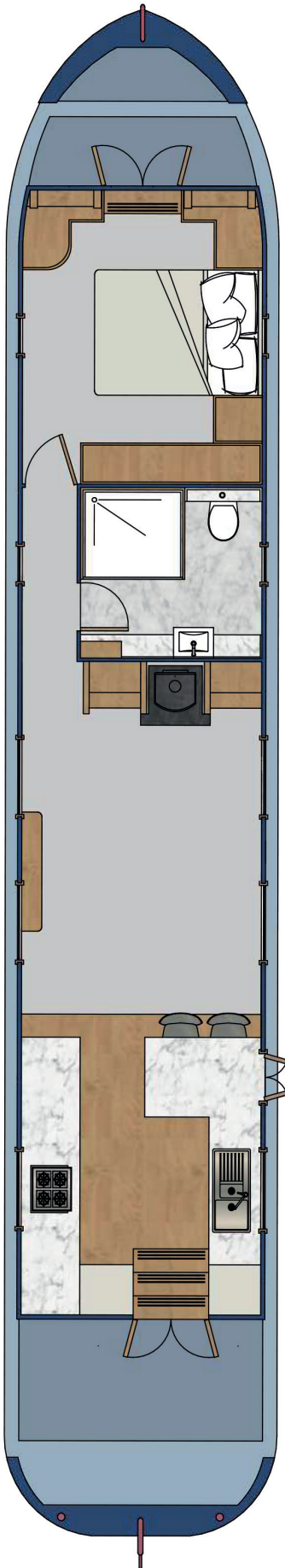

Baby Eurocruiser

from 50ft x 10ft

The Baby Eurocruiser is exactly the same as the Eurocruiser except, as the name suggests, just on a smaller basis. It's ideal for anyone looking to do a little more cruising and doesn't fancy the wider body of the Eurocruiser. Like its larger version the Baby Eurocruiser was remodelled in 2019 to feature a number of modifications and enhancements.

The distinctive square stern contains two attractive features – a wheel for steering, and built-in upholstered seating for socialising. At home on the canal and equally adept on the river, the Baby Eurocruiser is a spacious, beautifully appointed craft that's perfect for residential or leisure use, whether in the UK or on the waterways of Europe.

The build quality on the Baby Eurocruiser is evident from stem to stern. With a high gloss finish in marine enamel on the outside and fully lined inside with oak or ash veneer, this is a boat that keeps its good looks, year in, year out. Fixtures and fittings are to a high specification, including granite work surfaces and much more as standard. Space and quality combine to make the whole boat a wonderfully welcoming environment.

With one and two bedroom versions available, the Baby Eurocruiser is a boat you can customise with ease. From the boat's dimensions to the external colour scheme, through to flooring materials and curtain fabrics, we provide a very wide range to choose from. If you'd rather have a study than a second bedroom for example, just let us know.

Interior Finish

The interior lining is of oak or ash faced ply left natural or panted with matching hardwood trims, complimented by tongue & groove effect ceiling. Interior woodwork is finished in a high-performance, water based, clear acrylic which is extremely hardwearing, has minimal impact on the natural colour of the timber and is kinder to the environment.

Flooring options have been carefully selected for their aesthetic appeal and durability with a choice of carpet, laminates or solid hardwood in a comprehensive range of colours and designs.



Galley

The large galley offers contemporary units with plenty of storage and soft close doors and runners. Granite worksurfaces are included as standard with 4-burner full sized hob with stainless steel oven and separate grill under.

There is a household size stainless steel sink with monobloc tap, microwave and 12v fridge with freezer box are all supplied as standard.



Saloon

The saloon area is designed for freestanding furniture. A 32" flat screen TV is built into a under-gunwale unit.

A solid fuel stove set into a tiled hearth is centrally located on the forward saloon bulkhead with display units, shelving and storage on either side.

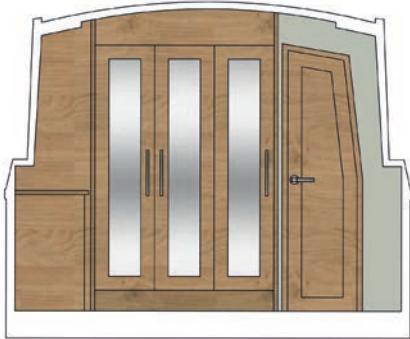

Master bedroom

The relaxing yet practical bedroom offers plenty of storage space, with a fixed double or king size bed with drawers under, bedside cabinets to both sides, full width mirrored wardrobes on the aft bulkhead, drawer unit opposite the foot of the bed and full height cupboards to either side of the glazed bow doors. There are ample 240v sockets in the bedroom as well as a TV aerial socket and reading lights over the head of the bed.

A second bedroom option can be fitted with a double bed, wardrobe and dressing table or a single bed, wardrobes and a desk/study area.

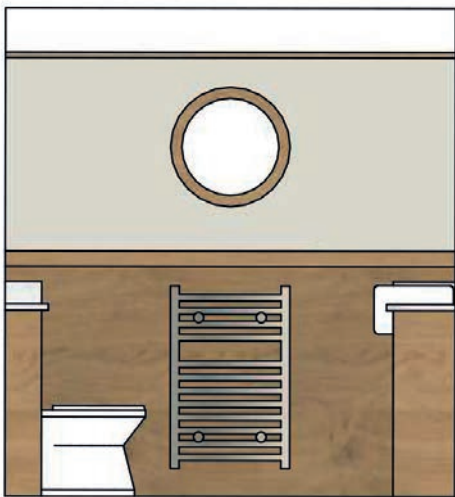

Bathroom

The spacious bathroom, with glass panelled hardwood doors, has a large corner 1200x800mm shower which is fitted with a waterproof panelling system that provides a contemporary and watertight finish.

A feature vanity unit has a hand basin with taps protruding out of the wall creating a 5 star hotel style feel, resting on the granite worksurface. An electric macerator pump out toilet is fitted as standard. All in all, a room that wouldn't be out of place in a modern day apartment.

Popular Optional Extras

- Canaline 60 Engine with PRM150 gearbox
- Curved stern with horseshoe shaped seating
- Pram cover
- Cratch & cover
- Rear bimini with LED lighting
- Satellite TV (manual or self seeking)
- Teak effect decking
- Victron 3000/120 combi inverter/charger
- Double glazing
- Solar panels
- Hospital silencer
- 2nd bedroom
- Black pack featuring: Black taps, sockets, light switches, shower enclosure and all iron monger (eg, mushroom/door vents, cabin hooks etc)

Please ask a member of staff for detailed costings and our full list of optional extras.

Exterior Finish

Layers of high-performance primers and undercoats are applied to the craft before being painstakingly coach-painted in beautiful high-gloss marine enamel. For areas such as deck, roofs and gunwales a non slip coating is applied.

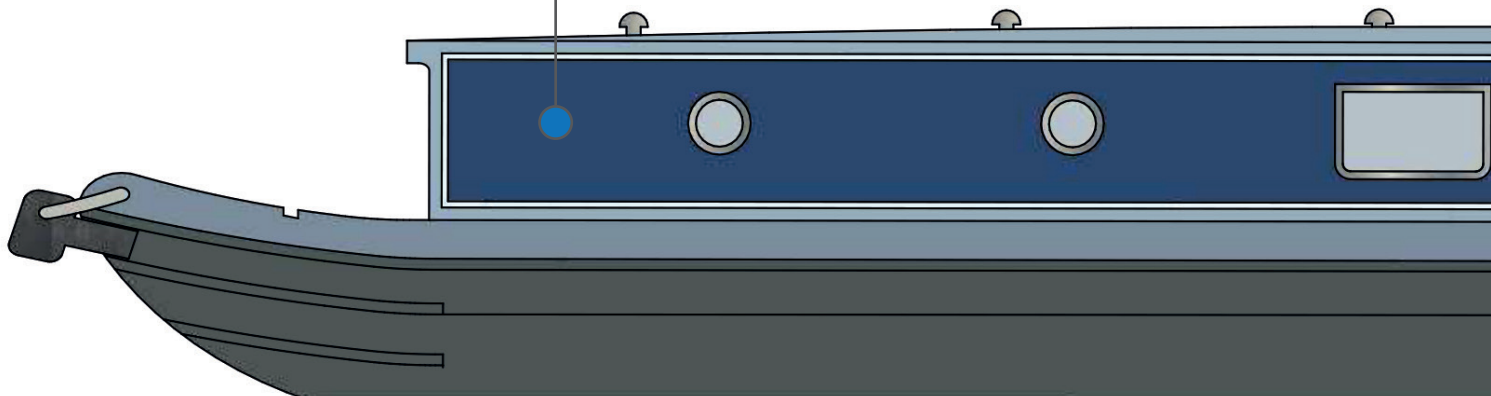

Technical

Steel Specification

10/6/5/4

Engine & Gearbox

Canaline 52, 4 cylinder diesel engine with twin alternators and PRM150 gearbox. Engine control panel with tachometer, water temperature, oil pressure and battery warning lights and multifunction LED display.

Heating & Hot Water System

In addition to the solid fuel stove in the saloon there is a Webasto diesel fired central heating system running three radiators and a heated towel rail as well as a 13 gallon calorifier for hot water. The twin coil calorifier is also connected to the engine circuit providing heat for hot water when running.

Additionally a 1kw immersion heater is fitted to give hot water via shore power.

Electrics

The 240V system on board simply plugs in to the shore line providing power to the brushed stainless steel double sockets throughout the boat. When cruising, a Sterling 2500/70 pure sine wave inverter/charger ensures you are never without power.

3 x 110A domestic batteries, which are charged by a dedicated alternator, provide 12v power through the high quality, dedicated distribution panel which carries individual breakers for all the appliances, as well as voltage and amperage readouts.

There are also dedicated batteries for engine starting and the 95Kgf Vetus bow thruster.

Rear Deck Area

The square cruiser stern is the perfect area for socialising whilst out cruising or when moored up.

The wraparound rear seating area provides plenty of storage and comes with weatherproof, upholstered, removeable cushions. The boat can be steered by either the hydraulic wheel steering or conventional tiller. Further seating/storage is provided alongside the steering position. Plenty of options are available to add your personal touch to this area too.

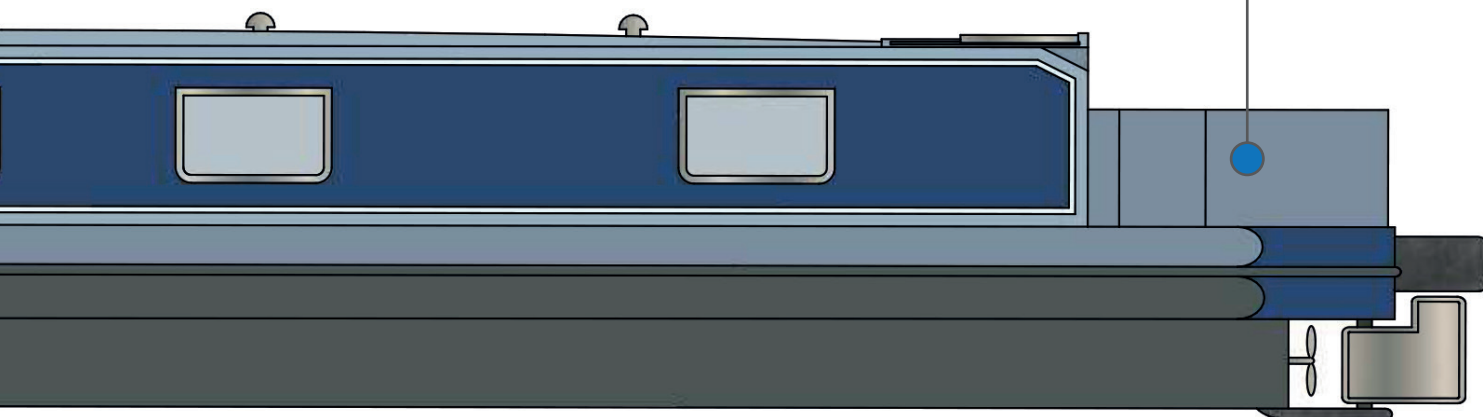

The Hoxton

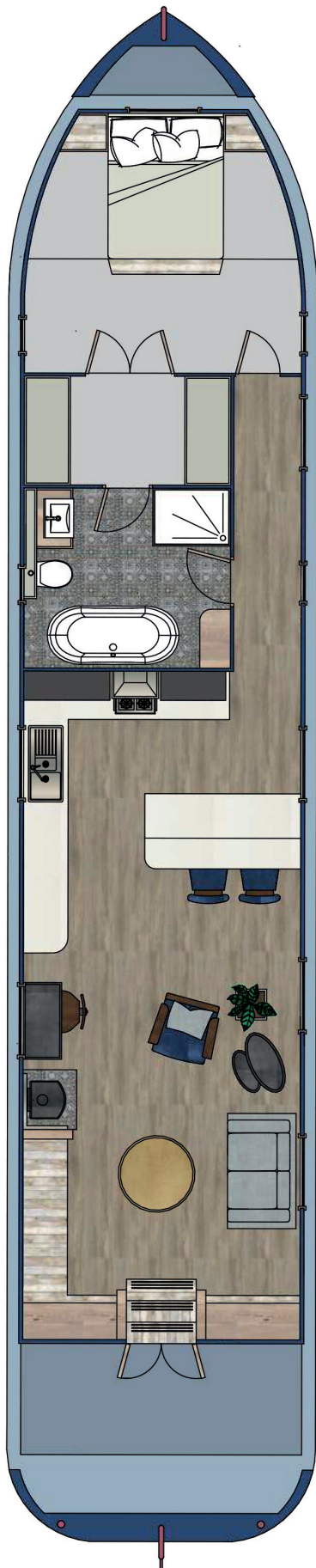

All New

The Hoxton

from 65ft x 12ft 6"

The Hoxton is the latest addition to our widebeam collection and is already proving to be popular thanks to its totally original design and styling which has an industrial feel with Scandinavian influences. The interior, which has been designed by interior design specialists, Bayswater Interiors, features a mix of a unique reclaimed wood feel combined with painted and veneer panels that all feature throughout the boat.

The wrap around bow turns the master bedroom into a master suite with a walk through dressing room featuring the most extravagant of wardrobes. The bathroom boasts both a large shower enclosure as well as a stand alone roll top bath. The galley will easily cater for the most ambitious of cooks featuring ample preparation area on granite worksurfaces, all the storage space you'll need together with 4 burner hob, double oven, extractor hood, microwave, integrated fridge and dishwasher, wine fridge and washing machine.

The Hoxton is a boat that stands out from the pack offering all the traditions of canal life with cutting edge interior design and all the features and appliances to enrich your living experience on board.

Interior Finish

The interior feel has been created by our specialist interior designers, Bayswater Interiors and features a unique approach that is very distinct with reclaimed wood feel lining, off set with painted and veneer panels.

Flooring options have been carefully selected for their aesthetic appeal and durability with a choice of carpet, tiles or solid hardwood in a comprehensive range of colours and designs.



Saloon

Feature full height storage and shelving units either side of the companionway with a 2 door base unit which also houses a wall hung 32" TV.

There is ample room to accommodate a sofa, chair coffee table and/or a dining table.

There is also a solid fuel stove (or a diesel option if you would prefer) set in designer feature tiles.

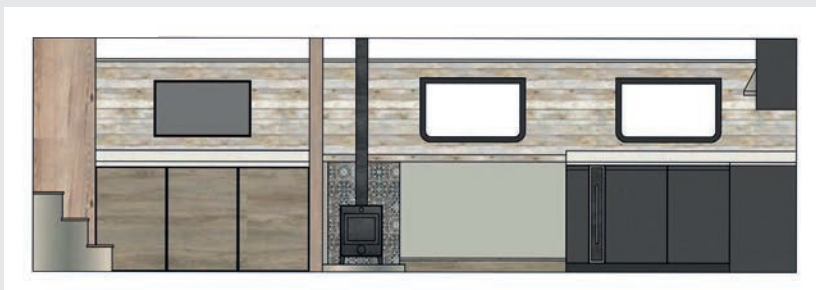
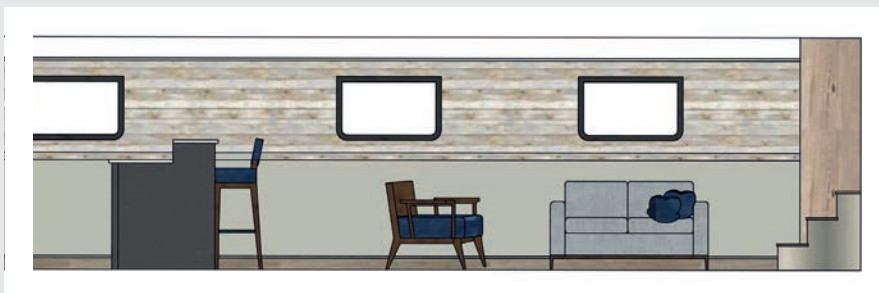

Galley

Contemporary push close kitchen cabinets in an L shaped design, with a separate unit opposite, to maximise on space and offer plenty of prep area on granite worksurfaces which are fitted as standard.

Feature herring bone tiled wall with a contemporary grey grout align the bathroom bulkhead with two overhead cupboards and a stainless extractor fan which sits above a 4 hob burner and double oven.

There is a full size household sink finished in dark grey with matching tap, as well as a washing machine and integrated fridge and dishwasher.

There is also a breakfast bar that can accommodate 3 bar stools.





Master bedroom

The idea here was to create a master suite feel that maximises on space. To help achieve this the wardrobes were removed, to a separate dressing room, along with the bow doors to allow the boat to effectively wrap around at the front which boasts a feature 30" window to allow in plenty of natural light and air.

The king size bed also has storage underneath.



Dressing room

The dressing room sits between the bathroom and the master bedroom where access is through a sliding fully glazed door hung from black ironmongery. It contains a host of hanging space as well as pull out racking to easily store everything you need.

Bathroom

The bathroom boasts both a stand alone roll top bath which has a black floor mounted tap and a 1200 x 800mm shower enclosure with sliding door and also features black designer wall mounted controls and furniture.

Floor tiles are feature black and white patterned tiles, with the wall behind the bath tiled in a "Metro tile" style. There is also a counter top sink with a surface black tap which sits upon a two tier bespoke shelving unit. An electric macerator pump out toilet is fitted as standard.



Popular Optional Extras

- Canaline 70 Engine with PRM260 gearbox
- Curved stern with horseshoe shaped seating
- Pram cover
- Cratch & cover
- Rear bimini with LED lighting
- Satellite TV (manual or self seeking)
- Teak effect decking and table
- Victron 3000/120 combi inverter/charger
- Double glazing
- Solar panels
- Hospital silencer
- Steel stern doors
- 6ft x 3ft double glazed roof light fitted in the saloon

Please ask a member of staff for detailed costings and our full list of optional extras.

Exterior Finish

Layers of high-performance primers and undercoats are applied to the craft before being painstakingly coach-painted in beautiful high-gloss marine enamel. For areas such as deck, roofs and gunwales a non slip coating is applied.

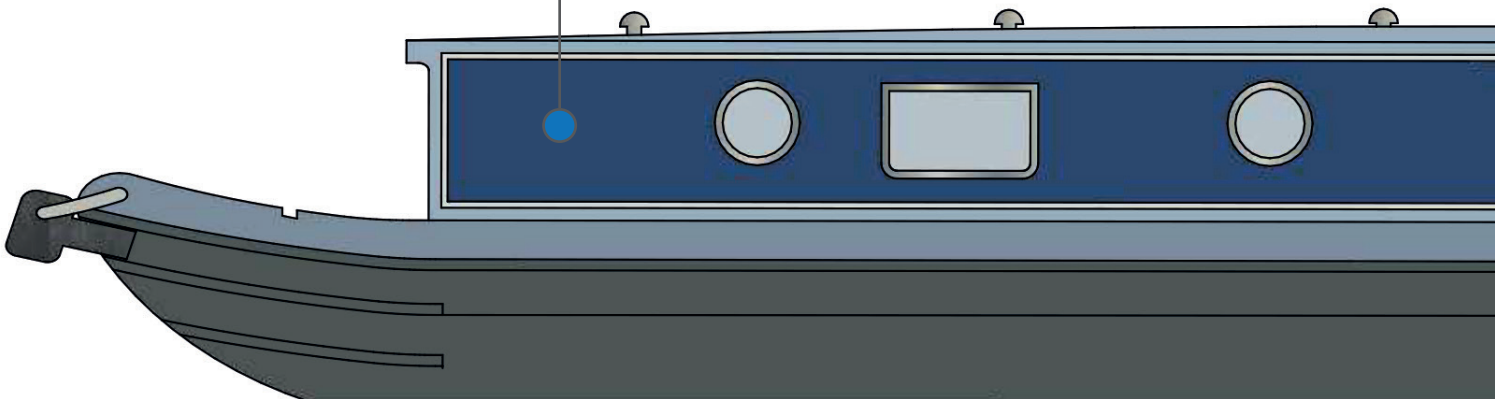

Technical

Steel Specification

10/6/5/4

Engine & Gearbox

Canaline 60, 4 cylinder diesel engine with twin alternators and PRM150 gearbox. Engine control panel with tachometer, water temperature, oil pressure and battery warning lights and multifunction LED display.

Heating & Hot Water System

In addition to the solid fuel stove in the saloon there is a Webasto diesel fired central heating system running three radiators and a heated towel rail as well as a 13 gallon calorifier for hot water. The twin coil calorifier is also connected to the engine circuit providing heat for hot water when running.

Additionally a 1kw immersion heater is fitted to give hot water via shore power.

Electrics

The 240V system on board simply plugs in to the shore line providing power to the brushed stainless steel double sockets throughout the boat. When cruising, a Sterling 2500/70 pure sine wave inverter/charger ensures you are never without power.

4 x 110A domestic batteries, which are charged by a dedicated alternator, provide 12v power through the high quality, dedicated distribution panel which carries individual breakers for all the appliances, as well as voltage and amperage readouts.

There are also dedicated batteries for engine starting and the 95Kgf Vetus bow thruster.

Rear Deck Area

The square cruiser stern is the perfect area for socialising whilst out cruising or when moored up. The wraparound rear seating area provides plenty of storage and comes with weatherproof, upholstered, removeable cushions. The boat can be steered by either the hydraulic wheel steering or conventional tiller. Further seating/storage is provided alongside the steering position. Plenty of options are available to add your personal touch to this area too, like a pram cover as shown.

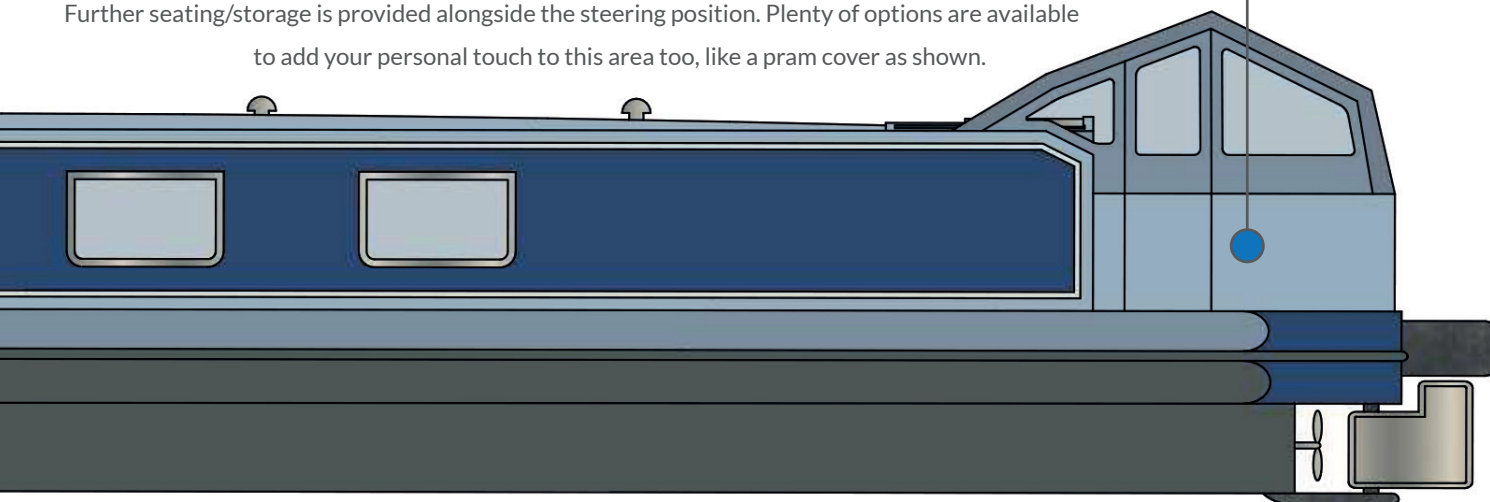

The Monarch

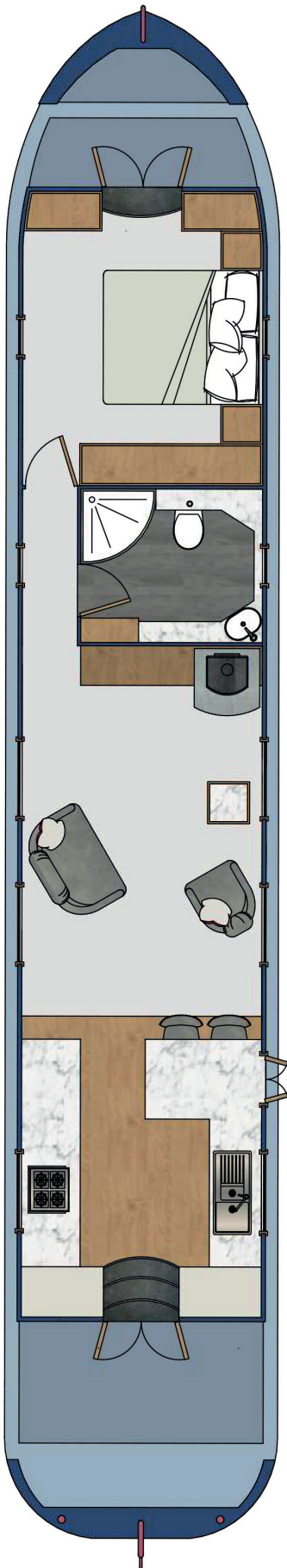

The Monarch

from 60ft x 12ft 6"

The main objective of this boat was to offer a boat that delivered living aboard a luxury craft yet came in under the £100,000 price point. We're happy to say the Monarch achieved its goal and it is still as popular today as it was when it was first launched.

From the moment you step onto a Monarch, you'll appreciate the space on board. A choice of layouts can be personalised to reflect your own taste.

As you would expect, an impressive specification is fitted as standard including oven, hob, fridge, microwave, fitted mirrored wardrobes, king size bed plus the option to upgrade with a host of extra luxuries like granite worksurfaces or a TV in the bedroom, and it all comes at a highly affordable price.

Interior Finish

The interior lining is of oak or ash faced ply left natural or painted with matching hardwood trims. Interior woodwork is finished in a high-performance, water based, clear acrylic which is extremely hardwearing, has minimal impact on the natural colour of the timber and is kinder to the environment.

To ensure both strength and stability, fitted furniture is constructed from high quality veneered board, again with solid hardwood cappings. Flooring options are chosen to be attractive, practical and hardwearing with a choice of carpeting, vinyls, laminates and wood. Available in a broad range of colours and designs and in any combination.

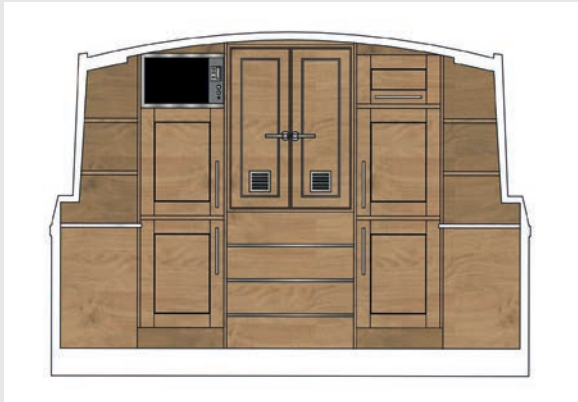

Galley

The large galley offers contemporary styling combined with mod cons and ample storage alike. Chunky hardwood worksurfaces (granite optional) are included as standard with 4-burner full sized hob, oven, grill and microwave.

A household size stainless steel sink with monobloc tap and 12v fridge with freezer box are all standard supply.

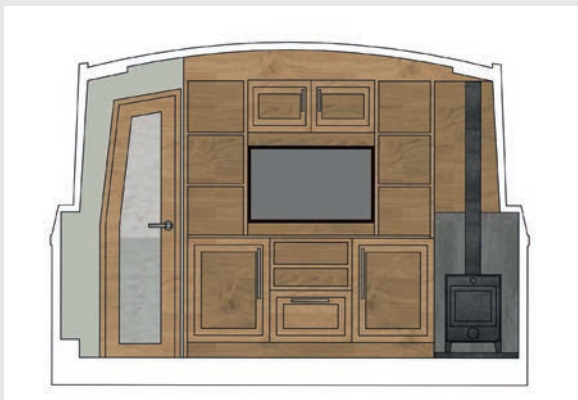
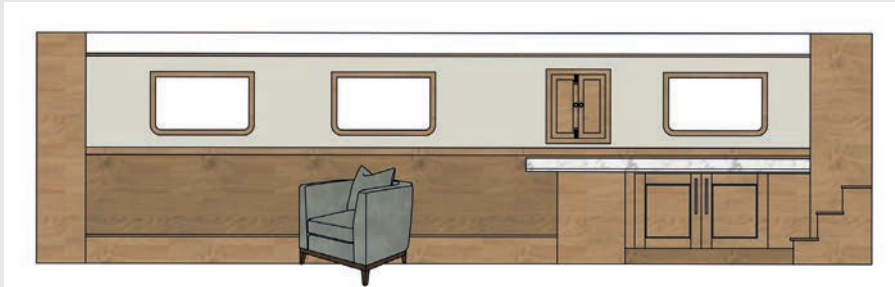

Saloon

The saloon area is designed for freestanding furniture. A 32" flat screen TV and a radio/CD player is housed, depending on layout, within a floor to ceiling hardwood multi-media centre with storage, or an under gunwale side unit.

A solid fuel stove sits on a tiled base with hardwood surround.



Master bedroom

The bedroom has been designed to create an environment of both relaxation and plenty of practical storage. There is a fixed double or king size bed with drawers under and overhead cupboard with down lights. There are multiple wardrobe units and a dresser unit with drawers at the foot of the bed. Glazed doors lead out from the bedroom on to the front deck.

A second bedroom/study option can be fitted with a double bed, wardrobe and dressing table or a single bed, wardrobes and a desk/study area.

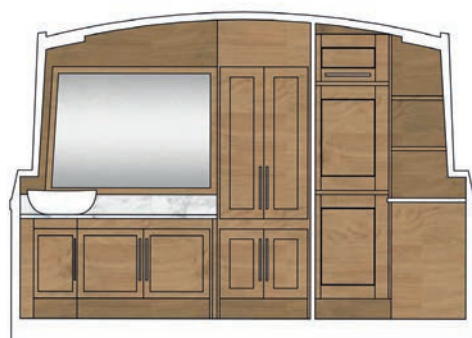
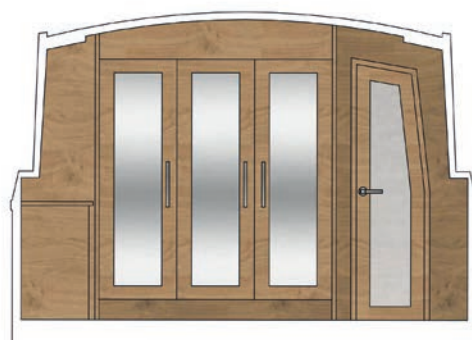

Bathroom

The spacious bathroom has mirrored units and a heated towel rail. There is a large corner shower which is fitted with a waterproof panelling system that provides a contemporary and watertight finish.

The feature vanity unit has a hand basin resting on a worktop to match the galley. The toilet is an electric macerator pump out.

Popular Optional Extras

- Canaline 70 Engine with PRM260 gearbox
- Curved stern with horseshoe shaped seating
- Pram cover
- Cratch & cover
- Rear bimini with LED lighting
- Bow lockers
- Bow thrusters
- Victron 3000/120 combi inverter/charger
- Double glazing
- Water and fuel gauges
- Hospital silencer
- 2nd bedroom
- Immersion heater
- Off white cabin sides
- Off white T&G effect cabin ceiling

Please ask a member of staff for detailed costings and our full list of optional extras.

Exterior Finish

Layers of high-performance primers and undercoats are applied to the craft before being painstakingly coach-painted in beautiful high-gloss marine enamel. For areas such as deck, roofs and gunwales a non slip coating is applied.

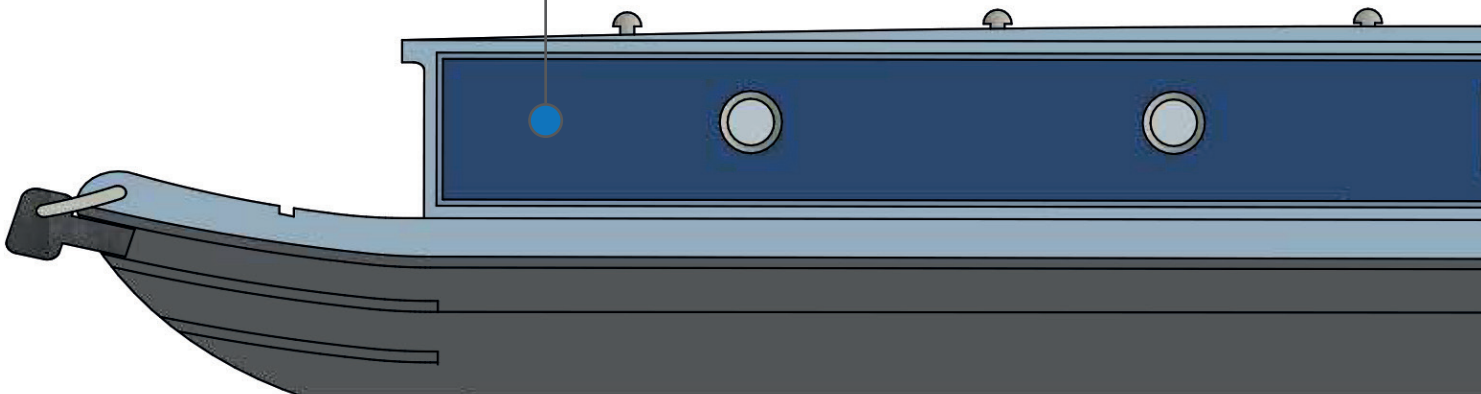

Technical

Steel Specification

10/6/5/4

Engine & Gearbox

Canaline 52, 4 cylinder diesel engine with twin alternators and PRM150 gearbox. Engine control panel with tachometer, water temperature, oil pressure and battery warning lights and multifunction LED display.

Heating & Hot Water System

In addition to the solid fuel stove in the saloon there is a Webasto diesel fired central heating system running three radiators and a heated towel rail as well as a 13 gallon calorifier for hot water. The twin coil calorifier is also connected to the engine circuit providing heat for hot water when running.

Additionally a 1kw immersion heater is fitted to give hot water via shore power.

Electrics

The 240V system on board simply plugs in to the shore line providing power to the brushed stainless steel double sockets throughout the boat. When cruising, a Sterling 2500/70 pure sine wave inverter/charger ensures you are never without power.

3 x 110A domestic batteries, which are charged by a dedicated alternator, provide 12v power through the high quality, dedicated distribution panel which carries individual breakers for all the appliances, as well as voltage and amperage readouts.

There are also dedicated batteries for engine starting and the 95Kgf Vetus bow thruster.

Rear Deck Area

As standard, the stern deck on the Monarch is a round cruiser style with taff rails. The engine control binnacle can either be located on the bulkhead or to the side, depending on customer requirements. A large gas locker located on the bulkhead provides space for 13kg gas bottles and doubles as a seat or step on to the roof. The floor of the deck is finished in a non-slip coating

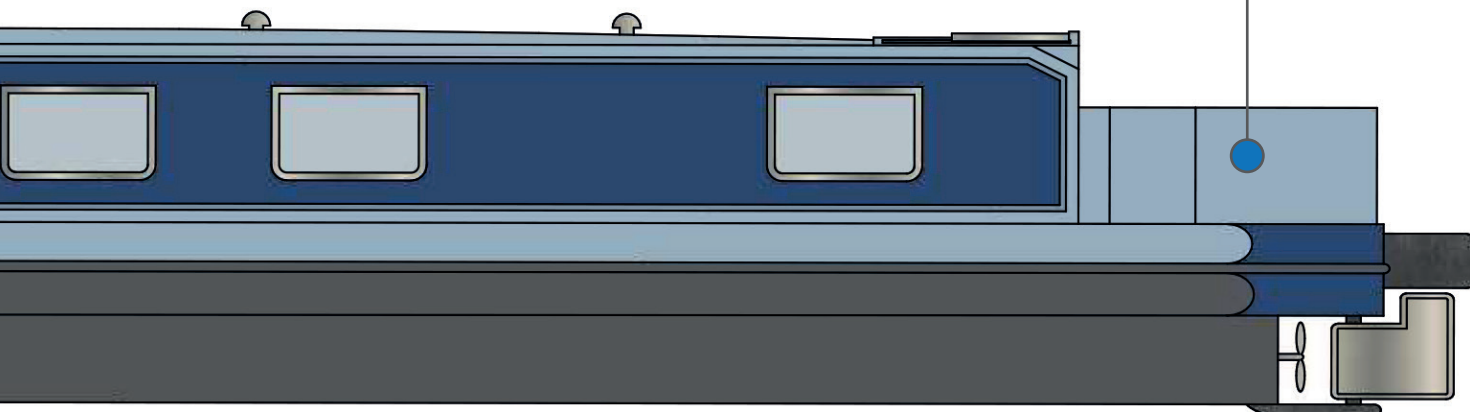



Making buying or selling
a new or used boat
an enjoyable experience

DERBY OFFICE
NEW BOAT & BROKERAGE SALES

Mercia Marina, Findern Lane,
Willington, Derbyshire DE65 6DW
[CALL 01283 890 888](tel:01283890888)



HANBURY OFFICE
NEW BOAT & BROKERAGE SALES

Hanbury Wharf, Hanbury Road,
Droitwich, Worcester WR9 7DU
[CALL 01905 953 888](tel:01905953888)

ALSO AT:

NOTHANTS OFFICE
BROKERAGE SALES

Dunchurch Pools Marina, Onley,
Northants CV23 8AN

DROITWICH OFFICE
BROKERAGE SALES

Droitwich Spa Marina, Hanbury Road,
Droitwich, Worcester WR9 7DU

MAIDENHEAD OFFICE
NEW BOAT SALES

TBS Boats, Bray Marina, Monkey Island Lane,
Bray, Maidenhead SL6 2EB
(Sat Nav SL6 2LL)

www.newandusedboat.co.uk



Our **PRICE PROMISE GUARANTEE** is your reassurance that *you cannot buy cheaper*. Being an **Approved Supplier** means we sell at exactly the same price as the manufacturers so we cannot be beaten on price, *even if you go direct!*