



— The —  
**Sailaway Collection**  
*from 60ft x 12ft*



## Sailaway

As the name implies, even with the Sailaway you'll be able to 'sailaway', as the propulsion system is fully installed. The hull comes with many integral parts as standard including mushroom vents, windows, doors, ballast, sub floors, stainless steel water tank, battens and a sealing coat of primer.

### Includes:

- 10/6/5/4
- Stainless steel water tank
- Fuel tank 60gallon (approx.)
- Canaline 52 4 cylinder diesel engine with twin alternators and PRM150 gearbox. Engine control panel with tachometer, water temperature, oil pressure and battery warning lights and multifunction LED display.

*Depending on requirement engine upgrade available*

- Sprayfoam insulation
- Broken concrete slab/WBP plywood
- Fully windowed including side doors

## Sailaway Painted

As above but the exterior is professionally painted in a high gloss marine enamel (one colour) and includes coach line

*Please ask a member of staff for a detailed costings and our full list of optional extras.*

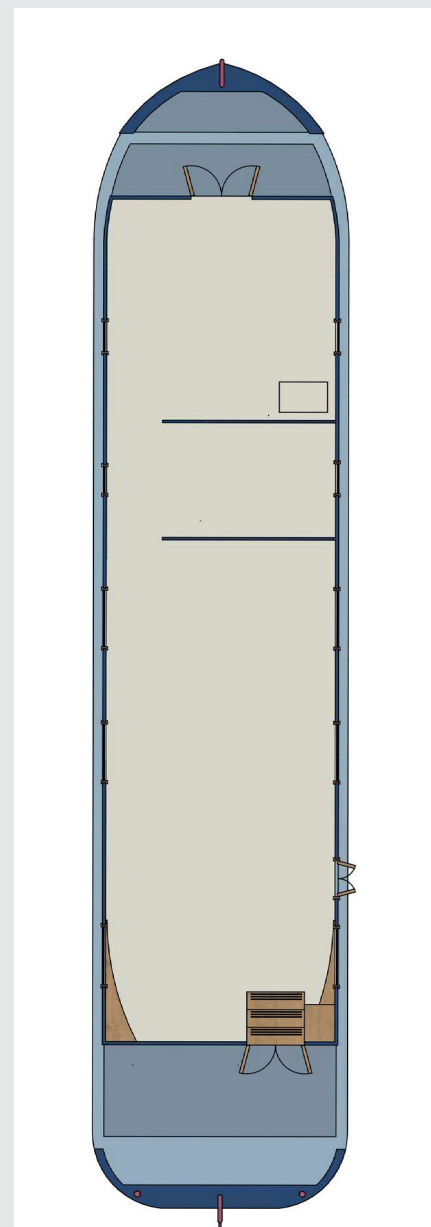



## Sailaway Lined

The Sailaway Lined, in addition to the sailaway, comes with the cabin fully lined in your choice of oak or ash veneer (painted option available) with hardwood trims. To give you a head start with the wiring, the 12v and 240v tails are also installed for you to connect to an AC/DC electrical control panel (control panel not included). Also included is a stainless steel water tank, ballast and 18mm plywood floor. When built from scratch, you get the choice of where we locate major items such as windows, vents and electrical tails. Another huge benefit of the Sailaway Lined is the exterior being professionally painted in a high gloss marine enamel including coach lines.

### As Sailaway but also includes:

- 240v cabling behind lining with loops at six separate points along boat
- Exterior paintwork, one colour with a coachline
- Two bulkheads (choice of positions)
- Fully lined in Oak or Ash veneer with hardwood trims (painted option available)
- Sprayfoam insulation
- Broken concrete slab/WBP plywood
- Fully windowed including side doors
- Two dividing bulkheads

## Sailaway Additions

Upgrade your Sailaway Lined with the 'Additions Pack' which also gives you the freedom to choose where we position everything you need, for example; radiators, sockets, any 12v or 240v tails, plumbing tails and bulkheads

### As Sailaway Lined but also includes:

- Webasto Diesel central heating with 3 radiators & a heated towel rail
- Hot & cold domestic water system
- 3 x 110A Domestic batteries
- 1800W Pure sinewave Sterling inverter
- 240v Ring main
- Landline hook up
- Galvanic isolator
- 6 x 240v Double sockets
- 12v Distribution panel
- LED lighting

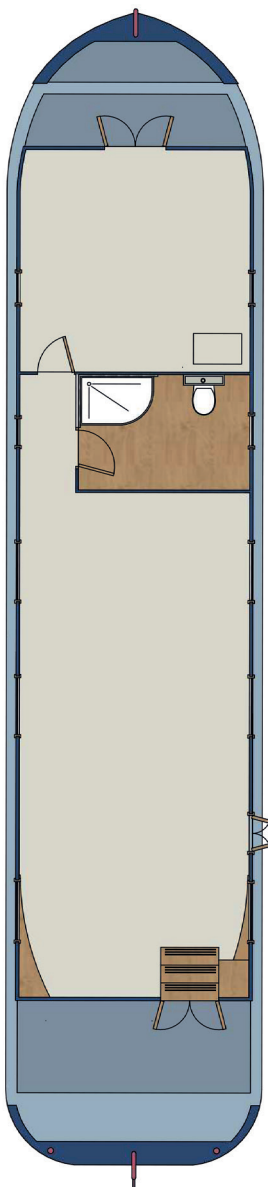



Making buying or selling  
a new or used boat  
an enjoyable experience

**DERBY OFFICE**  
**NEW BOAT & BROKERAGE SALES**  
Mercia Marina, Findern Lane,  
Willington, Derbyshire DE65 6DW  
[CALL 01283 890 888](tel:01283890888)



**HANBURY OFFICE**  
**NEW BOAT & BROKERAGE SALES**  
Hanbury Wharf, Hanbury Road,  
Droitwich, Worcester WR9 7DU  
[CALL 01905 953 888](tel:01905953888)

**ALSO AT:**

**DUNCHURCH POOLS MARINA**  
**BROKERAGE SALES**  
Mercia Marina, Findern Lane,  
Onley, Northants CV23 8AN

**EVESHAM MARINA**  
**BROKERAGE SALES**  
Evesham Marina, Kings Road,  
Evesham, Worcestershire WR11 3XZ

**COMING SOON - THAMES BOAT SALES**  
**NEW BOAT SALES**  
Bray Marina, Monkey Island,  
Bray, Maidenhead SL6 2EB

[www.newandusedboat.co.uk](http://www.newandusedboat.co.uk)