



AQUALINE  
MARINE LIMITED



## CANTERBURY WIDEBEAM

---

### SPECIFICATION

Aqualine's hand-crafted boats offer bespoke-level design and finish at an affordable price, backed by a reassuring after-sales support service.

All boats conform to the Recreational Craft Directive and come complete with CE mark plus a full 12 month warranty, and extended warranties on many parts. A full owner's manual with operating instructions and technical information is also provided.

The renowned Aqualine quality is once again evident in the Canterbury widebeam boat. A truly luxurious craft with an impressive level of equipment as standard, this boat offers exceptional value for money. The real attraction lies in the modular design which allows the layout to be altered to completely satisfy your requirements. There are also plenty of opportunities to customise your boat and you can choose the length, up to 70ft and beam up to 12 ft.



**Derby Office** Mercia Marina, Findern Lane, Willington, Derbyshire DE65 6DW Tel: 01283 707357

**Hanbury Office** Hanbury Wharf, Hanbury Road, Droitwich, Worcester WR9 7DU Tel: 01905 794445

[www.newandusedboat.co.uk](http://www.newandusedboat.co.uk)  
[www.aqualinamarine.co.uk](http://www.aqualinamarine.co.uk)

# TECHNICAL

## Engines

All the boats come with a 4 cylinder 2190cc Barrus Yanmar Shire 50hp diesel engine with PRM 150 hydraulic gearbox, one 50 amp and one 240 amp alternator. Standard control panel.

Depending on length/beam and/or usage we do recommend choosing a bigger engine.

Barrus Yanmar Shire 70hp, 4 cylinder 3319cc engine with a 50 and a 240 amp alternator. PRM 260 D2 hydraulic gearbox. Standard control panel. Upgraded control panel is available which features tachometer, oil pressure, voltmeter and water temperature gauges.

(All engines come installed, tested and running with one starter battery and a water lubricating stern tube).

## Tanks

Water tank, approx. 170 gallons, fully baffled, stainless steel. Diesel Tank, approx. 95 gallons with drain off. Pressure tested. Black waste tank, 47 gallons. (Only available with a macerator pump out toilet).

## Heating system

Diesel fired central heating system with timer which runs the Finrads and a heated towel rail in the bathroom, also provides hot water through a twin coil calorifier, with immersion. The calorifier is also connected to the engine cooling circuit meaning that the engine will heat the hot water.

## 240v power system

Power to 6 brushed stainless steel double sockets (plus a plastic socket concealed inside the TV unit) is supplied via a 240V system fitted as standard. Tested and installed to RCD standard for connecting to shore power when moored in a marina. When cruising, power is supplied from a Victron 1600 inverter with 70 amp charger, fitted as standard.

## 12v System

4 x 110 amp semi-traction domestic batteries, which are charged by a dedicated alternator. These are connected to a purpose-built distribution panel, and the system has circuit breakers for all of the appliances. The lighting is a combination of wall lights and LED down lighters throughout the boat. There is also under gunwale lighting in the corridor, and step lights at the bow and stern.

Bigger capacity and more robust batteries?

Upgrade to Gel Tubular batteries with a storage capacity of 600A/h (amp hours) which are designed to accommodate regular charging and discharging.

# EXTERNAL

## Steelwork

Shotblasted steelwork treated with an epoxy primer and two part polyurethane paint finish (except the hull which is blacked; blacking not suitable for salt/brackish water). Enhanced hull design built to CBA Code of Practice guidelines, with two full length rubbing strakes.

Hull blacking Upgrade

Have your hull prepared for cruising salt/brackish water. Also gives you, on average, a longer period between blacking.

<b>Steel Plating</b>	10mm/6mm/5mm/4mm	<b>Rubbing strakes</b>	Two full length (three at bow/stern)
<b>Style</b>	Cruiser	<b>Handrails</b>	T-section easygrip with scuppers for drainage
<b>Decks</b>	All self draining	<b>Bow lockers</b>	Fitted as standard
<b>Weed Hatch</b>	Quick release	<b>Anodes</b>	4 x 2.5kg magnesium anodes
<b>Fender eyes</b>	Brass Recessed (chrome available)	<b>Stern doors</b>	Steel, lockable
<b>Gas Locker</b>	To hold 2 x 13kg bottles (one provided)	<b>Bow doors</b>	Hardwood, glazed and lockable

## EXTERNAL (con't)

### Cruising pack

Front, rear and 6 side fenders, landline for connecting to shore power, mallet, 2 mooring pins, tiller and pin, windlass, lifebuoy, front and rear ropes, chimney and chinese hat, fire extinguishers, fire blanket, smoke and CO alarm.

### Paint scheme

We offer a range of designs and paint combinations (2 colour paint and coachline as standard) using a two part polyurethane paint. All decks, roof and gunwales are treated to give a non-slip finish.

Add that extra touch of style and individuality

Make sure your boat is the envy of the waterways by adding an extra colour - choose an additional colour for the roof, handrails, counterbands and painted panels or maybe all three.

### Window sizes

A mixture of portholes and windows (and a set of side doors) is used in the boat - refer to individual layout diagrams. Changes to window sizes can often be accommodated and we offer a choice between windows and portholes or a combination of both.

### Anodes x 4

These are designed to sacrifice themselves before the hull of your boat and, along with the galvanic isolator, help protect the hull.

### Bow lockers

Offer additional seating and handy storage for mooring pins, spare ropes and hose pipes.

### Side doors

Allows extra light and ventilation to flood in as and when you choose.

## INTERNAL

### Layout

As per the individual diagram, but the modular design approach means that rooms can be re-arranged to have the bedroom at the bow rather than at the stern or to include a second bedroom, whilst the length can be extended in one foot increments up to 70 feet to extend existing rooms and to a maximum of 12 feet on the beam (wider on request).

### Lining and wood type

All boats come with a choice of Ash or Oak. The roof in the standard craft is solid hardwood linear tongue and groove. The bedroom and bathroom have diagonal tongue and groove on the cabin sides. The remaining cabin area (galley, saloon) has a panelled effect, lined with deep hardwood trim. Full panelling or full tongue and groove also available.

### Flooring

The bedroom area is carpeted (with underlay) and the bathroom floor is tiled, whilst the remainder of the boat has a solid 20mm hardwood flooring fitted over a plywood sub floor. Full hardwood, carpet or galley tiling available at no extra cost.

### Interior finishes

We offer a choice of colours on soft furnishings, tiles, carpets (with underlay) and work surfaces as well as the exterior paintwork.

### Bedroom

Fixed 5 ft bed with drawers under, overhead cupboards with down lights and a cupboard with drawer at either side. Full length wardrobes provide that all important hanging space.

### Bedroom 2 (if required)

Bedroom 2 has a single berth and a workstation area to make this a practical, multi-use room. A second single bunk can be provided which also folds down in the daytime to make the bed into a sofa/seating area. Alternatively an extendable double bed can be fitted instead to make it a comfortable guest room. This bedroom can also be omitted giving more space in the saloon if preferred.

## INTERNAL (con't)

### Bathroom

An electric macerator (pump out) toilet, vanity unit with hand basin and full wall mirror with illuminated pelmet over. There is a shower wall, full-sized corner shower with a mixer unit. The shower is surrounded by a chrome quadrant screen. There is a heated towel rail, and shelving to provide further storage. A bath with shower over is available as an option, not to mention a choice of shower panel colours.

### Galley

Either a Split or U-shaped galley is available, both with solid hardwood doors and granite worksurfaces. There is a full-sized stainless steel hob and double oven, integrated fridge and deep full size stainless steel sink with monobloc taps over. The use of 'magic corners' provides an ingenious solution to the problem of hard-to reach corners. Overhead cupboards and shelving provide further storage. Stainless steel extractor fan.

### Saloon

Large saloon perfect for free standing furniture with a cast iron solid fuel stove. Depending on your layout there is a choice of various units to provide ample storage as well as to house the built-in 32" HD ready digital flat screen TV and DVD. There is also the opportunity to have a dining option included in the saloon, providing table and chairs for four, which is cleverly concealed under the gunwale when not in use.

TV cinema surround sound upgrade

Bring the movies to your boat with a multi purpose Phillips Fidelio SoundBar with wireless subwoofer and independent detachable Bluetooth® rear speakers which can be connected to any other Bluetooth® device for streaming music anywhere. Perfect whatever the occasion.

### Under gunwale lighting

Downlighting brings ambient and soft lighting in the bedroom and corridor.

### Step lights - bow and stern

Safety and style combined.

## OPTIONAL EXTRAS

DESCRIPTION	ONE BEDROOM	TWO BEDROOM
	57 X 10 FT from £125,950	65 X 10 FT from £137,350
HM Customs & Excise Ruling Widebeam vessels of a certain size may qualify for zero VAT, if they are being used as your sole place of residence. Please contact us for more details if you are considering a purchase for residential us.	£107,958 excl VAT	£117,458 excl VAT
Bespoke lengths and beam available Available in 1foot increments, fitted or unfitted.	POA	POA
Explorer Pack A distinctive curved stern that has an additional 2ft to maximise on al fresco dining or socialising with friends, whether moored or out cruising. Includes: Pram cover, Tek-Dek flooring, wheel steering, Rosewood/Oak fold-out table, additional deck locker and surround seating including upholstery and steel work.	£19,195	£19,195
Cruiser Stern Standard open deck stern with tiller.	Included	Included

## OPTIONAL EXTRAS

	ONE BEDROOM	TWO BEDROOM
<b>TECHNICAL</b>		
<b>Barrus Yanmar Shire 70hp</b> Recommended for boats of 60 feet or over.	£2,495	£2,495
<b>Bow thruster</b> Makes the boat so much easier to handle.	£3,495	£3,495
<b>Engine panel upgrade</b> Oil pressure, water temp and volt indicator gauges give instant feedback when pushing harder down rivers.	£295	£295
<b>Upgrade to Victron 3000/120amp</b> Silent AC power, ideal for all the mod-cons needed for residential living.	£1,895	£1,895
<b>Hospital silencers</b> Although the boats are fitted with double silencers these quieten the exhaust note even more. Ideal for stealth cruising.	£595	£595
<b>Travel power (240v alternator)</b> A 240v engine 3.5Kw generator/alternator pack to stay powered when not near a landline.	£3,250	£3,250
<b>Instrument security panel</b> An ingenious cover for cruiser sterns to secure and protect your engine instrumentation.	£345	£345
<b>600A/hr Gel Tubular Batteries upgrade</b> Increased capacity and a more robust battery package for the residential boater.	£1,195	£1,195
<b>Navigation lights</b> A requirement for night time cruising on certain rivers as well as improving the external look of your boat.	£495	£495
<b>Gauge pack</b> Keep an eye on your water, diesel and battery levels.	£1,200	£1,200
<b>EXTERNAL</b>		
<b>Chrome pack</b> External hardware including tiller arm, mushrooms, fairleads, coupled with stylish black framed windows.	£450	£450
<b>Painted panels</b> Give your boat a distinctive appearance with complementary matching colour	£495	£495
<b>Painted roof</b> Lighter shades keep the boat cooler in summer.	£545	£545
<b>Painted handrail</b> Add that touch of individuality as well as style	£395	£395
<b>Painted counterbands</b> A traditional touch to the stern	£295	£295

**EXTERNAL con't**

	<b>ONE BEDROOM</b>	<b>TWO BEDROOM</b>
<b>Interzone blacking upgrade</b> Greater flexibility on where you can cruise and moor (brackish water) as well as giving extra time between blacking.	£2,500	£2,500
<b>Houdini hatch</b> A 500 x 500cm sunroof for boats.	£1,200	£1,200
<b>Additional side doors</b> As the name suggests - an extra set of side doors.	£895	£895
<b>Side door internal screen</b> Turn your side door into a window allowing extra natural light but not rain in.	£545	£545
<b>Cratch A frame (Cover charged separately, please ask)</b> Frame for all weather cover to allow bow area to be used all year round.	£1,595	£1,595
<b>Outside Tap</b> Convenience and ease.	£385	£385

**INTERNAL**

<b>Choice of lining/design</b>	Ash or Oak	Ash or Oak
<b>Full T&amp;G throughout</b> A slightly more traditional wooden finish for a spectacular look throughout.	£2,200	£2,200
<b>Washing Machine</b> Full size washing machine integrated in either galley or bathroom.	£1,295	£1,295
<b>Granite breakfast bar</b> A stylish and complimentary add on to give convenient dining.	£495	£495
<b>12v fridge instead of 240v</b> Like a 240v fridge but 12v.	£495	£495
<b>Dining option</b> Magic design that allows 4 to dine then folds away into a neat cabinet under gunwale when not in use.	£1,650	£1,650
<b>Dinette - Pullman or L shaped</b> This convenient feature is perfect for dining or sleeping.	£1,950	£1,950
<b>Morso diesel stove</b> A clean way to bring extra warmth to your boat on those winter evenings.	£1,850	£1,850
<b>Lockmaster Reflex stainless steel diesel stove</b> A more stylish and contemporary way of achieving the above.	£1,850	£1,850
<b>Second bunk in bedroom 2</b> Another clever design feature - it's a bed by night then transforms into a sofa area by day...brilliant.	£1,200	£1,200
<b>Soft LED uplights</b> Low level lighting bringing an extra subtle ambience to guide you through the boat.	£495	£495

All prices include VAT at 20%. We reserve the right to alter the specification at any time without prior notice.

**INTERNAL con't**

	<b>ONE BEDROOM</b>	<b>TWO BEDROOM</b>
<p><b>Additional 12v or 240v sockets</b> Extra power points to meet your needs wherever you need them. Priced per socket.</p>	£175	£175
<p><b>Home cinema system</b> A multi purpose Phillips Fidelio SoundBar with wireless subwoofer and independent detachable Bluetooth® rear speakers which can be connected to any other Bluetooth® device for streaming music anywhere.</p>	£945	£945
<p><b>Satellite tv</b> More channels at your disposal on those long winter evenings.</p>	£945	£945
<p><b>Additional tv aerial</b> Choose extra tv aerial points so you never miss your favourite programme. Ideal for the bedroom.</p>	£100	£100
<p><b>Frosted glazed privacy door</b> Create more personal space easily.</p>	£695	£695
<p><b>335L pump out tank</b> Bigger tank means increased times between pump outs.</p>	£645	£645
<p><b>Bath with shower (instead of corner shower)</b> The best of both worlds. Soak away while you cruise away or take a quick shower whenever you feel the need.</p>	£945	£945
<p><b>Limestone tile upgrade</b> A contemporary addition to an already modern bathroom.</p>	£445	£445
<p><b>Cassette toilet</b> Choose a cassette instead of a pump out tank.</p>	FOC	FOC

**Explorer Pack**

A distinctive curved stern that **has an additional 2ft** to maximise on al fresco dining or socialising with friends, whether moored or out cruising.

**Includes:**

Pram cover,  
Tek-Dek flooring,  
Wheel steering,  
Rosewood/Oak fold-out table,  
Additional deck locker  
Surround seating including upholstery and steel work.

# FLOOR PLANS

Typical illustration of a widebeam layout which can be modified to accommodate most requirements. Please note that the dining option and bath shown are optional extras. The Canterbury layout is incredible flexible allowing rooms to be added or omitted to provide extra space if required. Length and beam can also be altered up to 70x12ft (wider on request).

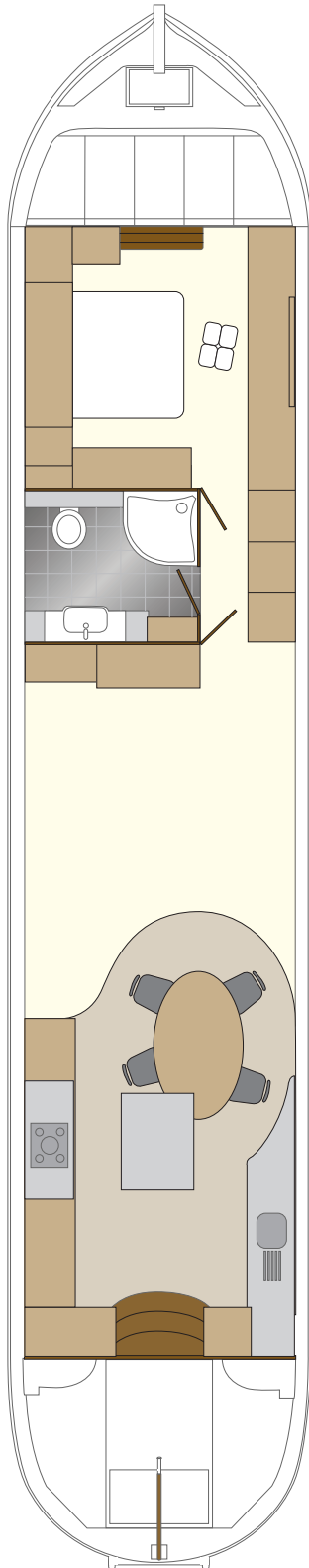

**CANTERBURY**

One bedroom

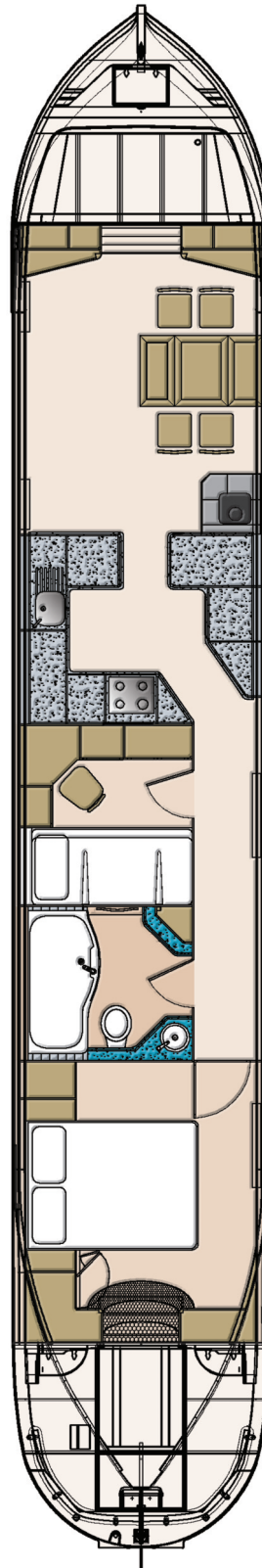

**CANTERBURY**

Two bedroom